

INNOVATIVE SOLUTIONS OF INDUSTRIAL EQUIPMENT

**SATEC**  
IMPROVING YOUR COMPANY



# COLUMN GUARDS

CATALOGUE 2020





## COLUMN GUARDS

Damage resulting from forklift truck or another vehicle collisions with pillars compromise the strength of the entire building structure, and may cause its collapse. Expensive repairs and overhaul-related standstills have a negative impact on entire company's performance.

To prevent this, column guards must be installed. Polymer column guards designed on the basis of cutting-edge technologies, protecting posts, columns and pillars. By protecting such elements, they also protect buildings, equipment and personnel.

### POLYMER GUARDS ADVANTAGES



#### Easy Installation

Quick installation without sophisticated tools and specialised installation teams



#### Low maintenance costs

No corrosion, scratches and repainting. Repeated impact absorption without replacing guards



#### Flooring protection

Guards are not fixed to the flooring preventing it from damage in the event of collisions with guarded columns



#### Modular design

Adjustable to various column sizes. Guards can overlap up to the required height

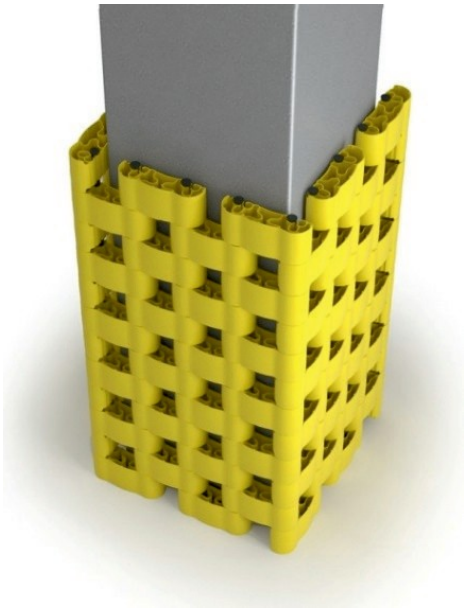

## SPECIFICATION

- Column cross-sections: square, rectangular, round, elliptical, I-section
- Column dimensions: **width from 100 mm to ∞**
- Material: HDPE, colour: warning yellow
- Design: Set of modules connected to one another around a column using polymer bars, which facilitates enclosing columns of any shape and size.
- Guard dimensions: **thickness 78 mm; height 500 mm (basic protection), 1,000 mm (standard protection) or a multiple of these dimensions.**

## DESCRIPTION

- Interlocking, modular construction that adapts to suit your site. Easy 'wrap around' installation with no drilling, velcro or fasteners.
- Integrally moulded, curved energy absorbers provide a staged impact response to protect columns and walls. Excellent performance is achieved in a wide range of environments including cold stores down to -40°C.
- Withstands 2.7 tonne collisions at 2 km/h, without any damage. Protects columns against collisions at 6 km/h. Conforming to international regulations: FEM 10.02.02 and AS 4084
- Profiled interior perfectly absorbs impact
- Modular design adjustable to a column shape





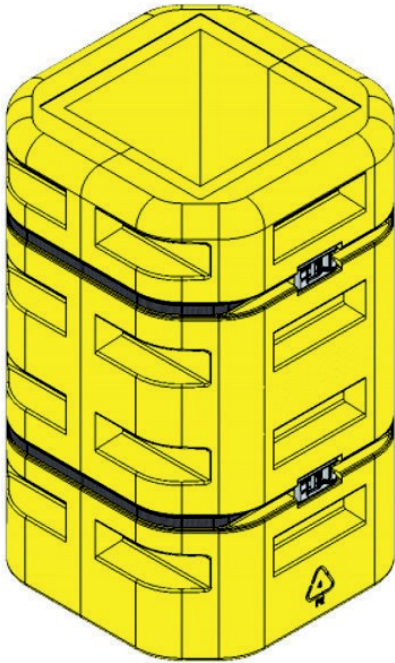

## SPECIFICATION

- Column cross-sections: square, round, I-section
- Column dimensions: **from 150 x 150 mm to 410 x 410 mm**
- Material: MDPE, colour: warning yellow – perfectly visible
- Design: 2 modules assembled together using durable belts with ratchet clamps preventing their unfastening at impact
- Guard outside dimensions:  
**height 1,045 mm x width 650 mm**

## DESCRIPTION

- Vehicles protected from damage & collision with structural columns – the absorbing function will also reduce the risk of injury to forklift operators
- Option to adjust the guard to intermediate column sizes by means of inserts and mounting a half of a guard a column.
- Possibility to stack guards on top of each other increased visibility for operators of high vehicles
- Collision tests: 2.5 tonnes at 11 km/h
- Solid and tight fit to the column thanks to tension straps with ratchet buckles
- Simple installation with 2 no hook & loop straps
- Lower recess concealing column footing with anchors
- Pedestrians will benefit from visible safety awareness
- Made in the EU from durable MDPE plastic
- Resistant to all weather conditions in the temperature range -40 to +90 °C
- Optional steel floor bar to protect against impact of pallets and forklifts

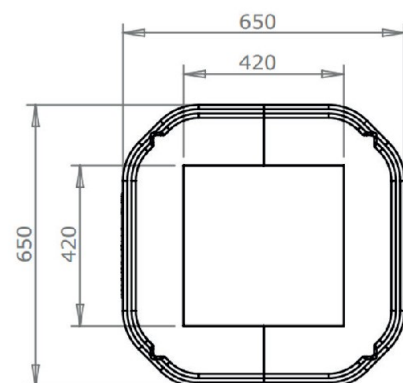
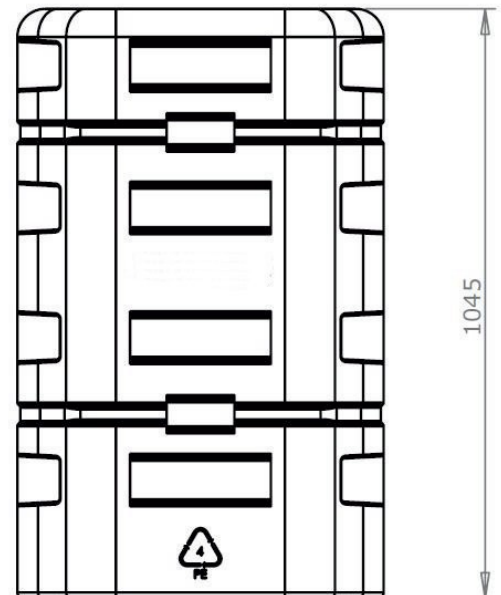



## SPECIFICATION

- Column cross-sections: square, round, I-section
- Column dimensions: **from 80 x 80 mm to 254 x 254 mm**
- Material: MDPE, colour: warning yellow – perfectly visible
- Design: 2 modules assembled together using durable belts with ratchet clamps preventing their unfastening at impact
- Guard outside dimensions:  
**height 1,045 mm x width 410 mm**

## DESCRIPTION

- Absorbing protection solution for both warehouse columns and also for lighting columns in service yards & carparks
- Vehicles protected from damage & collision with structural columns – the absorbing function will also reduce the risk of injury to forklift operators
- Option to adjust the guard to intermediate column sizes by means of inserts and mounting a half of a guard a column.
- Collision tests: 2.5 tonnes at 11 km/h
- Durable clamping belts with ratchet clamps
- Simple installation with 2 no hook & loop straps
- Lower recess concealing column footing with anchors
- Pedestrians will benefit from visible safety awareness



**Type BS 150**

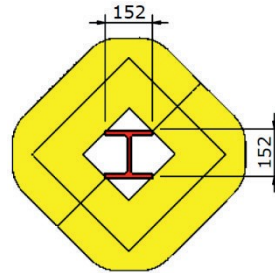

**Type BS 200**

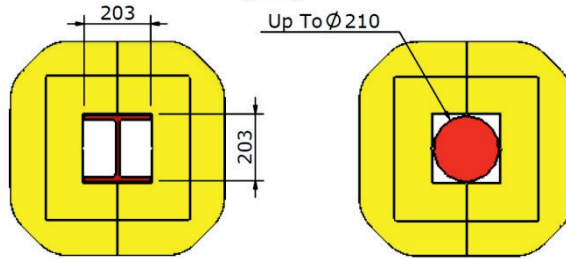

**Type BS 250**

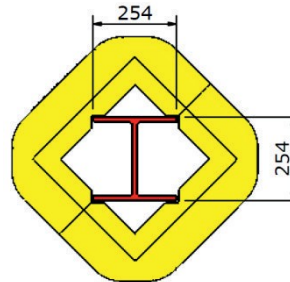

**Type BS 300**

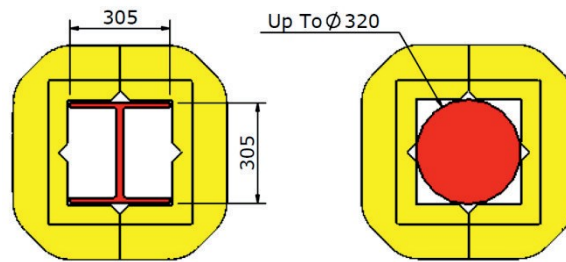

**Type BS 370**

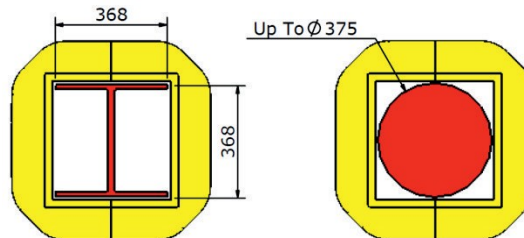

**Type BS 400**

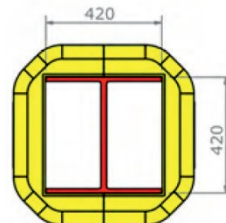

**Type BS 600**

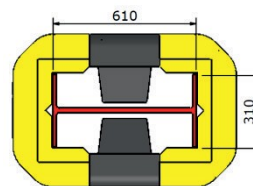

**Type SlimBS 80**  
80x80 SHS

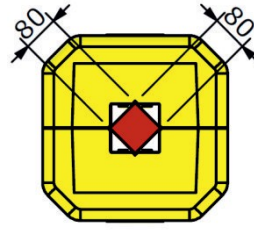

**Type SlimBS 90**  
90X90 SHS

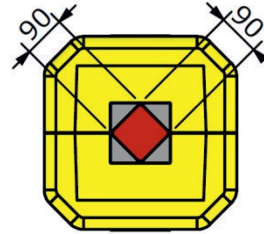

**Type SlimBS 100**  
100X100 SHS

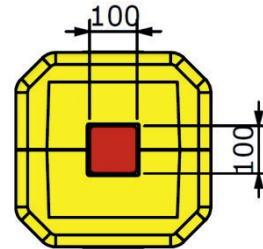

**Type SlimBS 120**  
120X120 SHS

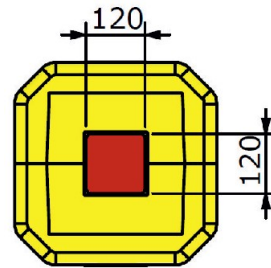

**Type SlimBS 150**  
152X152 UC  
150X150 SHS

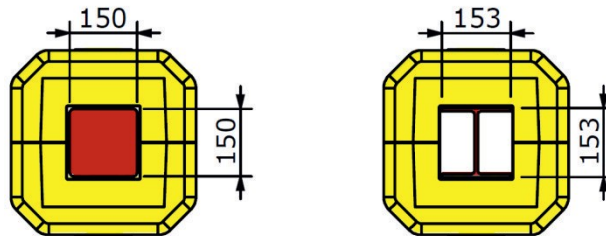

**Type SlimBS 200**  
203X203 UC

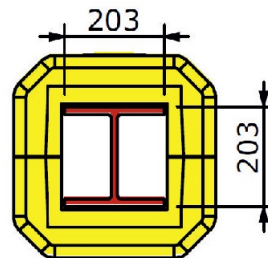

**Type SlimBS 250**  
254X254 UC

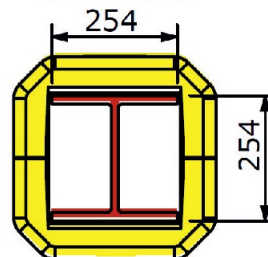





## SPECIFICATION

- Column cross-sections: square, rectangular, I-section
- Column dimensions: **from 200 x 200 mm to 600 x 600 mm**
- Material: HDPE, colour: warning yellow
- Design: 4 corners with fasteners assembled together using durable belts with ratchet clamps preventing their unfastening at impact.
- Guard dimensions:  
**height 1,100 mm x thickness 125 mm**

## DESCRIPTION

- Additional inserts make it possible to adjust a guard to columns and columns of various shapes and sizes, depending on actual needs. The modular design facilitates replacement of individual, e.g. damaged, elements.
- Resistance to 2,948 kg impact at 3.3 km/h
- Durable clamping belts with ratchet clamps
- Inserted elements – flexible adjustment to column size
- Hi-visibility plastic requires no welding or painting.

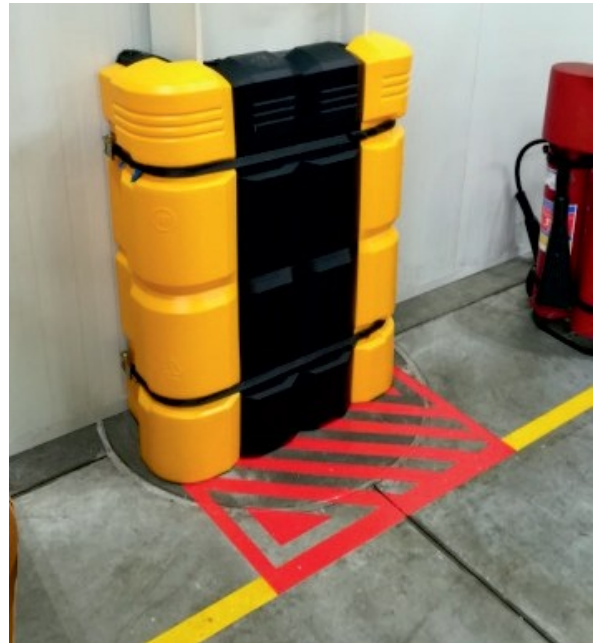



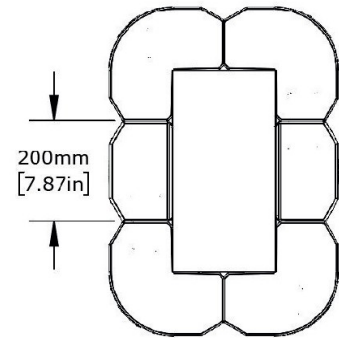
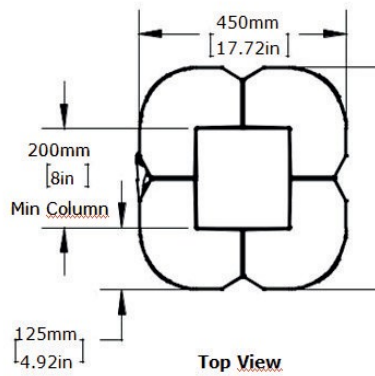
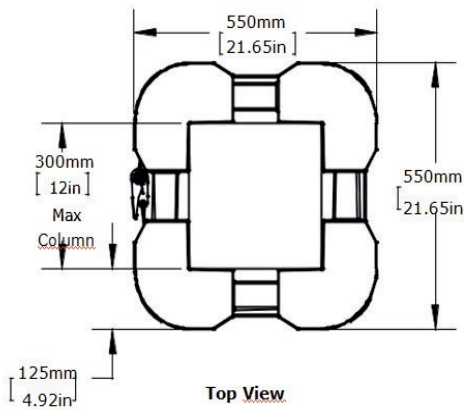
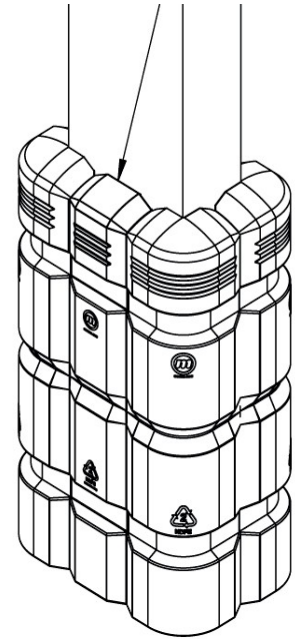
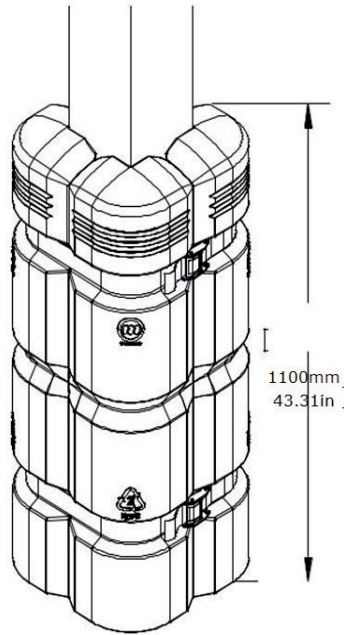
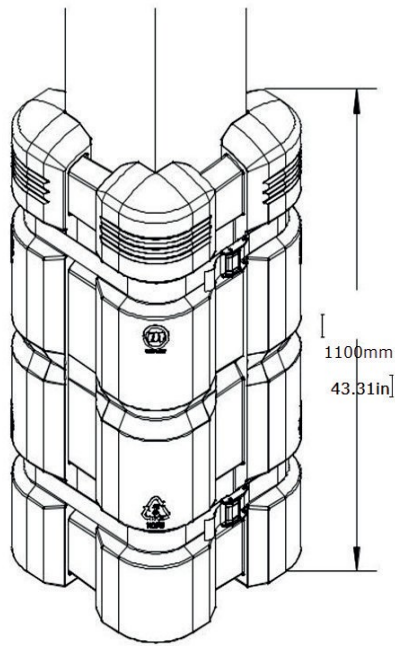



## SPECIFICATION

- Column cross-section: square, rectangular
- Column dimensions: **from 200 mm to 700 mm**
- Material: LDPE, colour: warning yellow – perfectly visible
- Design: 4 modules attached to one another with bolts, around a column
- Guard outside dimensions:  
**height: 1,000 mm x thickness 110 mm**

## DESCRIPTION

- Additional inserts make it possible to adjust a guard to columns and columns of various shapes and sizes, depending on actual needs. The modular design facilitates replacement of individual, e.g. damaged, elements.
- Resistance to 2,948 kg impact at 3.3 km/h
- Durable clamping belts with ratchet clamps
- Inserted elements – flexible adjustment to column size
- Hi-visibility plastic requires no welding or painting.

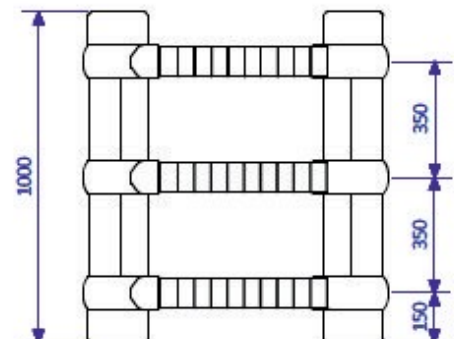
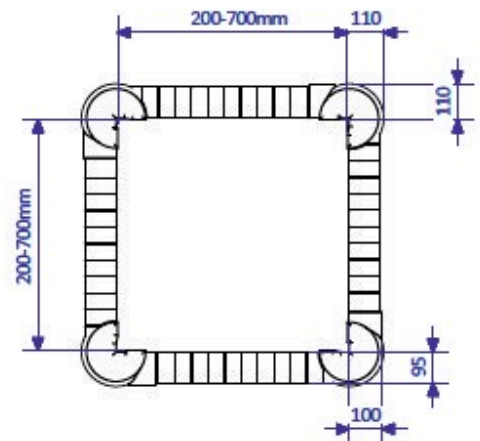





IKEA Industry

Location: Konstantynow Lodzki, Poland

SAMSUNG SDS 

Samsung SDS Europe Ltd.  
Location: Speyer, Germany

 **PEPSICO** | Polska

Pepsi-Cola General Bottlers Poland  
Location: Michrów, Poland

 **Husqvarna**

Husqvarna  
Location: Mielec, Poland



Samochody  
Użytkowe

Volkswagen Poznan  
Location: Wrzesnia, Poland

**XPO**Logistics

XPO Contract Logistics  
Location: Gromadka, Poland

*Kellogg's*

KELLOGG'S  
Location: Kutno, Poland

**NTA**



NTA Sp. z o.o.  
Baltic General Cargo Terminal,  
Location: Gdynia, Poland

 **LOTOS**

LOTOS S.A.,  
Location: Gdansk, Poland

## Interested?

Need more info or an official price offer?  
**Contact us!**

 0048 691 467 772  
 [info@satec-europe.com](mailto:info@satec-europe.com)

